

Dear Directors,

We are pleased to be hosting the Region 2, 2C Concert and Sightreading Contest March 4-5th. The staff at Byron Nelson High School and the Northwest ISD wants to do everything within our means to assist you and your students in having a successful contest experience. Please do not hesitate to contact us if we can do anything to help you or if you have any special needs or concerns.

In this packet, please find the following:

1. Map to Byron Nelson High School
2. Bus Routing Map indicating traffic flow to the campus entrance, drop off and pick up point, directions of traffic to bus parking, etc.
3. Fine Arts Wing Map indicating equipment and student unloading, auditorium entrance, directions to percussion holding area, routing of students, exits, etc.
4. Contest schedule
5. Blank seating chart (please complete chart and bring it with you)

To facilitate a timely contest, we have built travel time into the schedule. Your warm up time is a maximum of 30 minutes. However, the built-in travel time of 10 minutes allows you to get situated on stage and then still begin your program at the proper performance time. If you intend to use risers, please have chaperones accompany you that can assist our stage crew in setting up and tearing down the risers. We have 4 Wenger risers (4x8), and various height legs for them. We do not have any "pie piece" risers, so if you need those please bring them. Allowing our stage crew to concentrate solely on chairs, stands, and percussion will facilitate a timely contest.

When you arrive, approximately 20 minutes prior to your warm up start time, please drive your buses to the "student drop off area" noted on the enclosed map. The director should check in at the contest office (PAC 109) with 3 copies of your conductor's scores, 2 copies of your stage set up and your Form 1's. Then unload students from the busses and proceed to the waiting area prior to going into the warm up room. Make sure to leave your cases on your buses to facilitate the flow of the contest. A student guide will meet you in the waiting area and lead you to the warm up room at the appropriate time. Percussionists and other students needing to unload equipment from the truck will proceed through the hallway to the truck unloading area (see map of school). We ask that your percussion be prepared to move their equipment in to the back stage area 20 minutes prior to your performance. They may then return to the warm up room and wait. Please designate one chaperone or student to stay with the equipment until your percussionists return a few minutes prior to your performance set up.

The following equipment will be available in warm-up:

Peterson Tuner, McAdams Metronome, Yamaha Harmony Director.

Please watch the clock and understand that your allowed warm up is 30 minutes from the time you enter the warm up room. Due to the size of some of the performing ensembles, you may not have as many stands as requested on set up chart in the warm up room. When it is your time to go to the stage, your guide will lead you through the auditorium and to the stage. Our announcer will introduce you and your selections once you are seated on stage. When you are finished performing, you will exit the stage to your left and go directly into the band hall for sightreading. After sightreading, you will exit out the

back doors to the bus parking area. Please do not plan on leaving percussion equipment on stage for other bands since there is insufficient room to store it.

Scores and judge's sheets may be picked up in the contest office following your sightreading. This contest office will also be the hospitality room for directors, judges and staff.

Byron Nelson High School will provide the following percussion equipment on stage:

- Set of 4 Ludwig Timpani
- 36" Concert Bass Drum on suspended stand
- Orchestral Bells – Deagan
- Yamaha Xylophone – Rosewood Bars
- 2 Yamaha Marimbas – Acoustalon
- Yamaha Vibes
- Deagan Chimes
- Zildjian Tam-Tam on Stand

Byron Nelson High School will provide the following percussion equipment in the sightreading room:

- 36" Concert Bass Drum on suspended stand (No Mallet)
- Bells
- Yamaha Xylophone – Acoustalon

You will need to provide all of your own small percussion equipment such as Snare Drum, Crash and Suspended Cymbals, Triangle and Tambourine. Additionally, you must bring all of your own sticks, mallets and/or beaters.

NO CONCESSION STAND WILL BE PROVIDED AT THE CONTEST

There will not be an area for eating at the contest site. Please plan accordingly. Nearby restaurants are: *Taco Casa, Wendy's, Taco Bueno, Pizza Hut, Dickey's BBQ, Subway, Sonic*

Our school begins at 8:35 AM and dismisses at 3:45 PM. This will impact traffic flow. Please plan accordingly if your buses are here at that time.

Please review all the enclosed materials and contact us immediately if you have any concerns. We hope you enjoy your experience with the Region 2, 2C UIL Concert and Sightreading Contest.

Sincerely,

Jed Weeks

Jim Boulet

Michael Moore

Byron Nelson HS Bands

We're changing our privacy policy and terms. This [still matters](#). [Learn more](#) [Dismiss](#)
To see all the details that are visible on the screen, use the "Print" link next to the map.

Google



Directions to BNHS:

377 North (past Hwy 114)

Right on Bobcat Blvd

Left across the front of School to east side

See school map for drop off/parking info



BYRON NELSON HIGH SCHOOL
FIRE EXITING DIAGRAM

FRONT OF SCHOOL

N →

TRUCK DRIVING
BUS DRIVING
FIRST FLOOR

↓
BUS PARKING

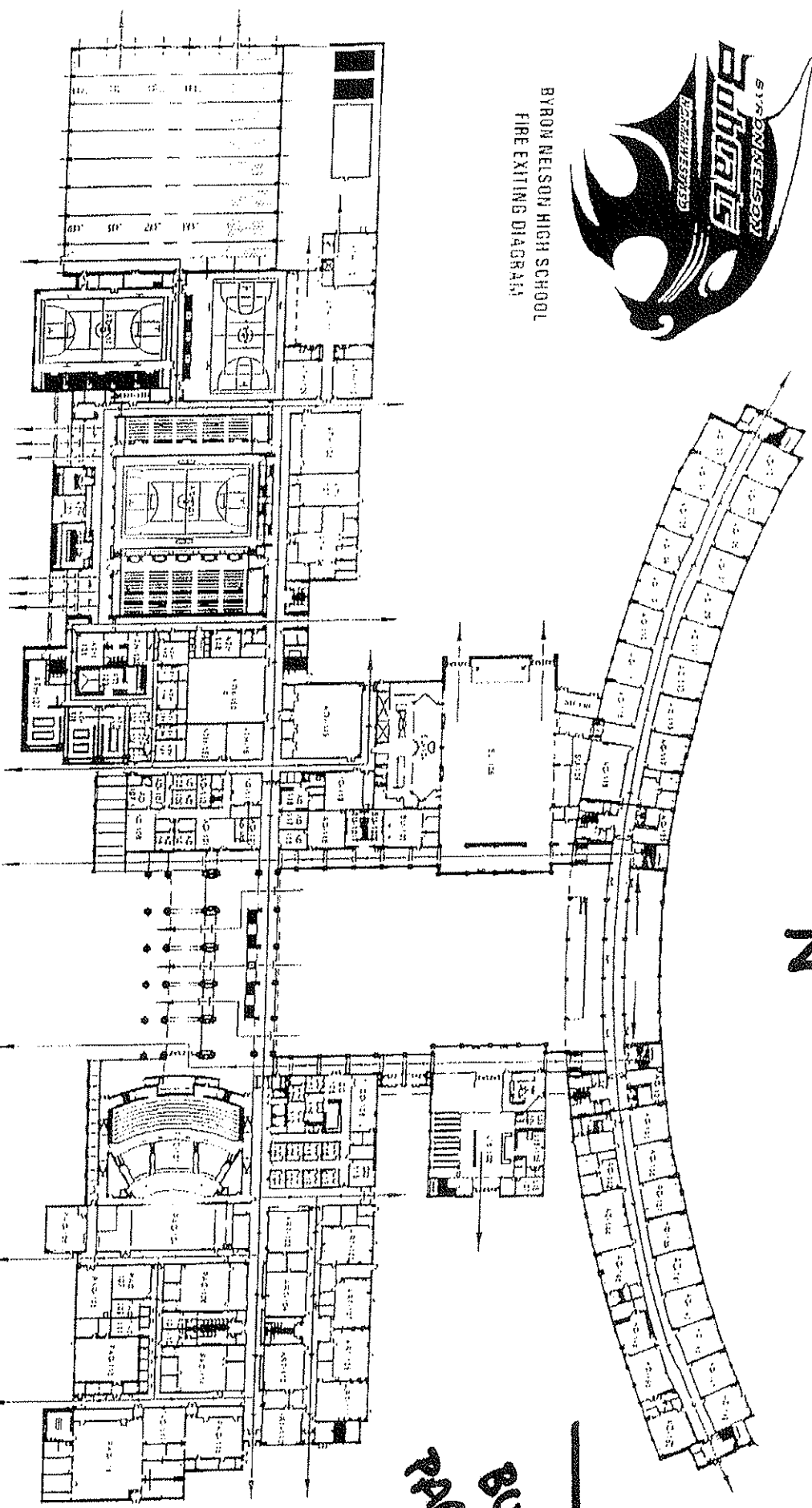

FRONT OF SCHOOL

TRUCK
UNLOADING

BUS DROP OFF

FIRST FLOOR

OFFICE

DR

SR

EXIT

PARKING
BUS
(MARCHING
BAND LOT)

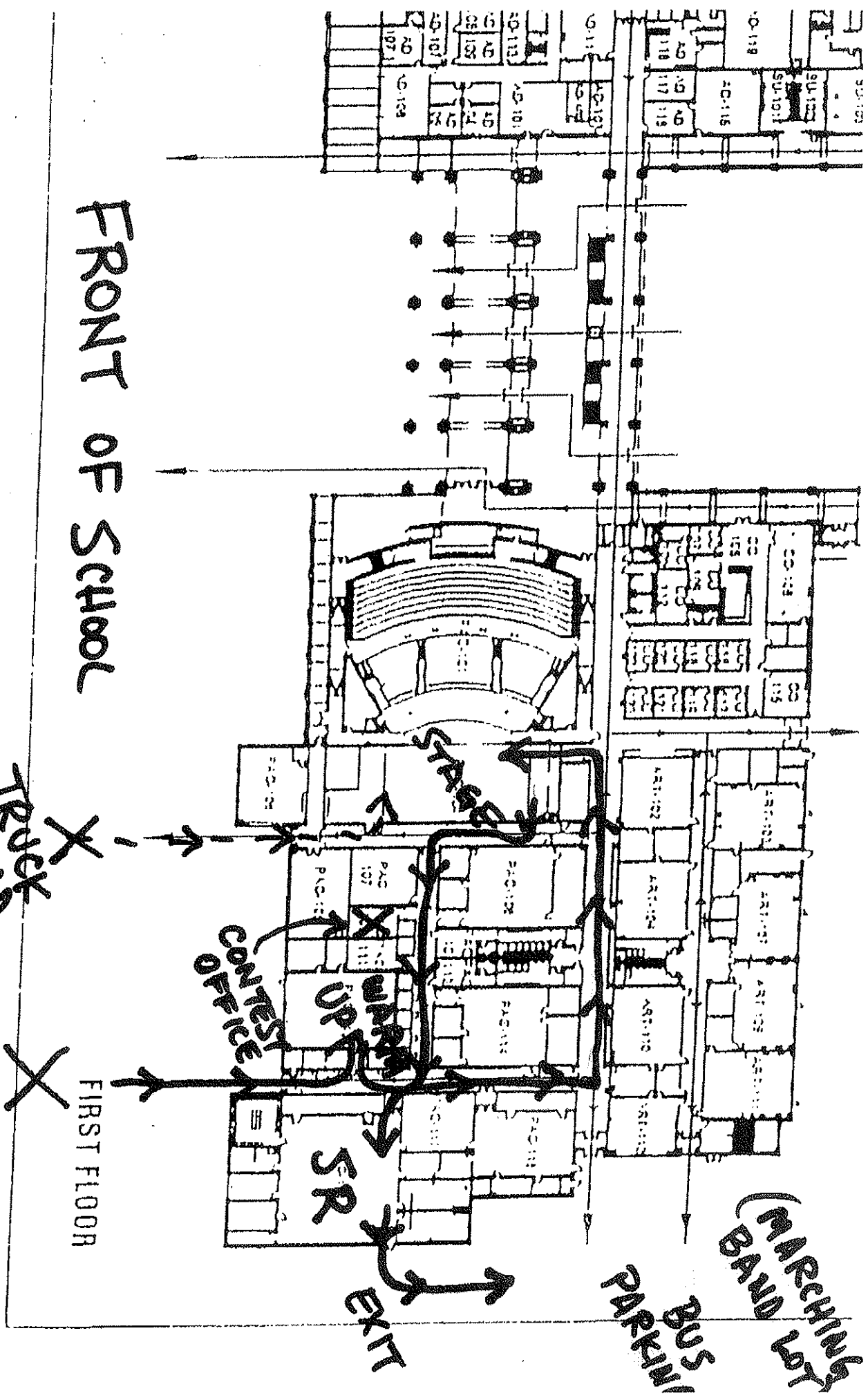

SEATING CHART FOR: _____ DIRECTOR _____

Name of Band

_____ NON-VARSITY (# _____) _____ VARSITY

Number of CHAIRS and STANDS

Row #1 - _____ & _____

Row #2 - _____ & _____

Row #3 - _____ & _____

Row #4 - _____ & _____

Row #5 - _____ & _____

Please draw set-up as accurately as possible including percussion set-up.

We will need to borrow:

- _____ Chimes
- _____ Vibraphone
- _____ Xylophone
- _____ Bells
- _____ Timpani
- _____ Percussion Cabinet

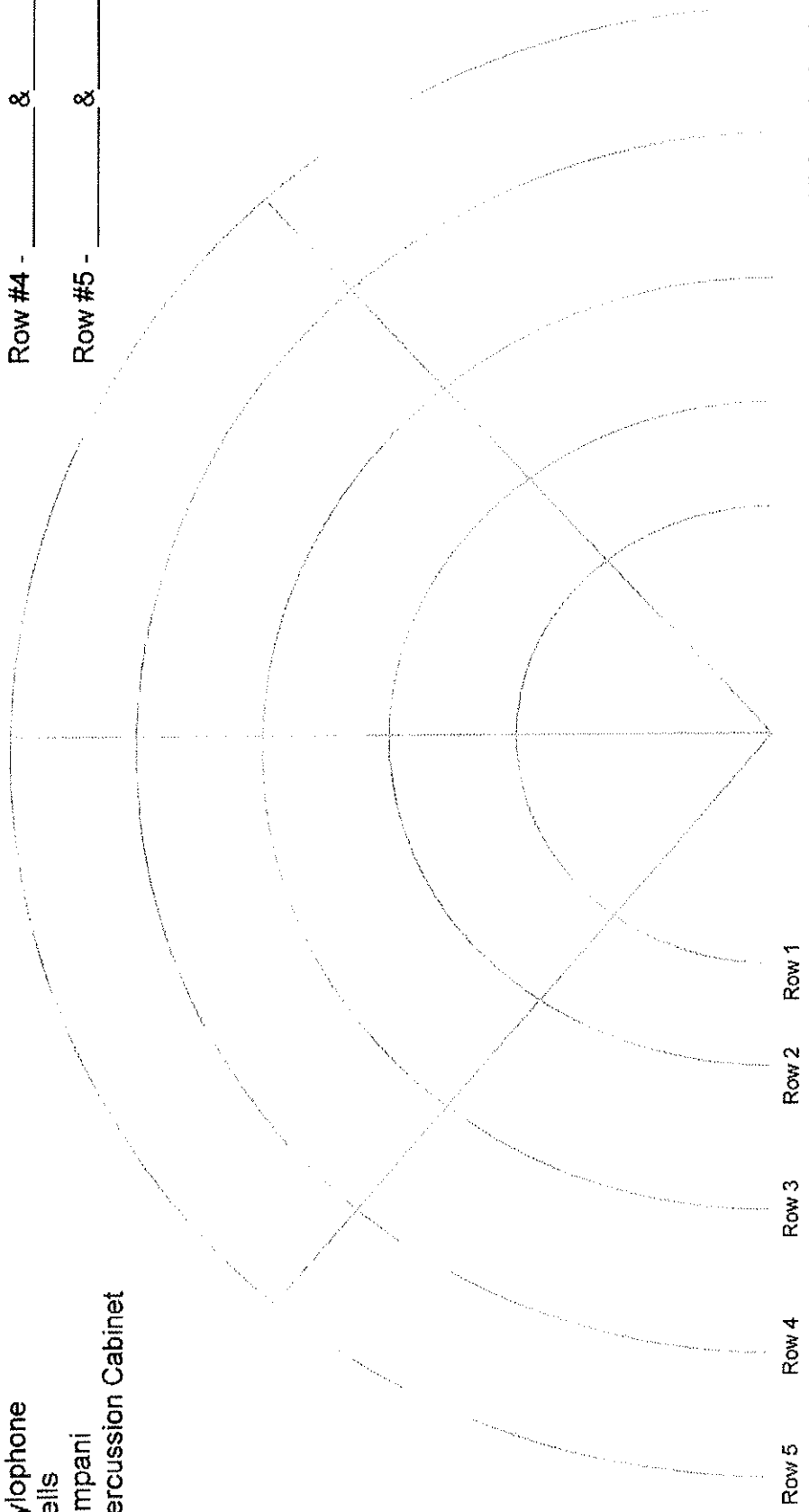

Place an "0" for chair placement.
Place an "X" for stand placement.